

IFT-BoreLoc® Provided 6” – 8” AWWA C500 Insertion of Gate Valves

Suggested Specifications

BoreLoc® provides Full Ductile Iron Body – Rotating Disc Gate Valves. These R/D valves have been used since 1908. The Rotating Disc Gate Valves clean themselves with every operation. Deposits are removed in travel, so nothing builds up on the seating surfaces that could cause leakage. Discs are free of pockets that could collect solids. The rotating action of the discs creates a different seating position each time the valve is closed. Uneven or excessive wear is prevented and the sealing components remain smooth and operational years longer without maintenance or replacement. Since the discs rotate, they cannot foul on the body guides

1. BoreLoc® provided Full Ductile Iron ASTM-A536 Bonnet, Disc, Wedges & Body. Rotating disc Gate Valves shall meet or exceed all pertinent requirements of ANSI/AWWA C500 gate valve standards and shall surpass ANSI/NSF 61 or drinking water components.
2. Valves shall be Factory Assembled and Tested not allowing disassembly or reassembly in the field prior to customer use. Assembly of a valve in the field after factory testing is not allowed. A valve requiring cutting the pipeline through the valves body prior to final assembly is not allowed. Boreloc® provided C500 4"-8" valves will have a Factory Seat Test of 250 PSI & Factory shell tested to 500 PSI and installed into the pipeline without disassembling after Factory testing has been performed.
3. Valve stems are 304 Stainless Steel ASTM A276 (standard) Consult factory for other stem materials.
4. Valve stems shall have “anti-friction” Delrin / Nylatron thrust washers to reduce operating torque.
5. Valves are available in NRS (Non-Rising Stem) with a 2” square operating nut or hand wheel, either Left hand open or Right hand open. Also available are OS&Y (Open Stem & Yoke) configurations.
6. The operating mechanism is triple O-ring sealed to completely seal against leakage past the stem. Two O-rings are provided above the thrust collar and one below. Upper O-rings can be replaced under pressure without removing the stem when the valve is fully opened. Rotating disc valves provide independent wedging and seating with the rotating gate that cleans seating surfaces when operated.
7. The valve disc is composed of ASTM A536 ductile iron and the body seat rings Bronze B148 C95400 and disc seat rings Bronze B584 C89833. Lower Wedge & Upper wedge A536 Grade 65-45-12.
8. Valves shall have internal and external surface coating with fusion bonded epoxy coating conforming to AWWA C500 and NSF61 certified protects both inside and outside of valve.
9. Valves shall have Type 304 or 316 stainless steel bolts and nuts for long-life corrosion protection.

10. Valves shall be cast, machined, assembled, with Final testing in the USA Factory. Valves shall be warranted by the manufacturer against defects in materials or workmanship for a period of ten (10) years from the date of manufacture.

AWWA valves shall be provided by Certified IFT-Boreloc®.

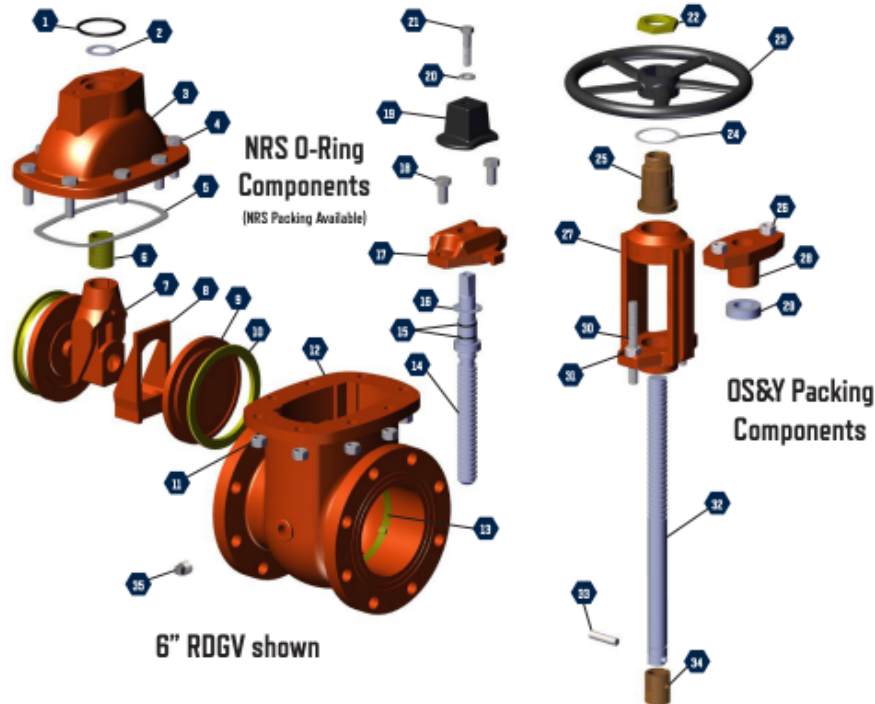

No.	DESCRIPTION	MATERIAL	No.	DESCRIPTION	MATERIAL
1	Stuffing Box O-Ring	Rubber	18	Op-Nut	Cast Iron
2	Thrust Washer	Plastic	20	Op-Nut Washer	Stainless Steel
3	Bonnet	Ductile Iron	21	Op-Nut Hex Bolt	Stainless Steel
4	Bonnet / Body Hex Bolt	Stainless Steel	22	OS&Y Wheel Nut	Bronze
5	Bonnet / Body Gasket	Garlock #3200	23	Handwheel	Cast Iron
6	NRS Stem Nut	Bronze	24	Yoke Nut Washer	Plastic
7	Upper Wedge	Ductile Iron	25	Yoke Nut	Bronze
8	Lower Wedge	Ductile Iron	26	Packing Gland Nut	Brass
9	Disc	Ductile Iron	27	Yoke	Ductile Iron
10	Disc Seat Ring	Bronze	28	Packing Gland	Ductile Iron
11	Bonnet / Body Hex Nut	Stainless Steel	29	Packing	Garlock Style 18
12	Body	Ductile Iron	30	Yoke Stud	Stainless Steel
13	Body Seat Ring	Bronze	31	Yoke Hex Nut	Stainless Steel
14	NRS O-Ring Stem	Stainless Steel	32	OS&Y Stem	Stainless Steel
15	Stem O-Rings	Rubber	33	OS&Y Stem Pin	Stainless Steel
18	Thrust Washer	Delrin	34	OS&Y Stem Nut	Bronze
17	NRS O-Ring Stuffing Box	Bronze	35	Pipe Plug	Stainless Steel
18	Stuffing Box Hex Bolt	Stainless Steel			

Kennedy® is a Trademark of Kennedy Valve Co.

AMERICAN® (AFC) is a Trademark of American Cast Iron Pipe Company



IFT-Boreloc® is a family member of International Flow® Technologies, Inc
 Contracts & Billing: 221 N. County Line Road. Mustang, OK 73064 – 800-221-3332
AWWAINsertValves.com